



GTP Global Textile Partner NEWS

June
2010

For better weaving.

 Trade fair highlights from
ITMA ASIA + CITME 2010

 Steel Heddle sets new record: longest
frame without center support

 New finishing line for flat steel
heddles put into operation

 GTP increases its presence on
the worldwide web

Dear Reader,

From 22-26 June 2010, Shanghai will for the second time be hosting the largest showcase of cutting-edge solutions for textile manufacturers. This milestone event combines the unique strengths of the ITMA brand and China's most important textile event - CITME. Due to a more positive outlook for 2010, the trade fair is expected to attract some 100,000 trade visitors. This represents a 10% increase from the last combined show in 2008, which drew 90,000 visitors from 96 countries and regions.

We at GTP Global Textile Partner are looking forward to welcoming you to what we consider to be a trade fair that one simply cannot afford to miss. And we feel that you will find visiting the GTP booth B03 (hall E4) to certainly prove worthwhile. At ITMA Asia + CITME 2010, GTP Global Textile Partner and Steel Heddle® will proudly introduce our new heddle range that meets the most demanding needs and firmly places weaving mills worldwide ahead of the competition. Supplemental to this, you will also be able to learn about our newest developments in weaving accessories, designed to achieve an improved weaving performance in terms of better fabric quality, higher productivity and energy savings.

As your Global Textile Partner, we remain committed to leading you to better weaving.



Philip De Bie
General Manager
GTP Global Textile Partner



ITMA Asia +
CITME 2010
22-26 JUNE 2010

Hall E4
booth B03



Trade fair highlights at ITMA ASIA + CITME 2010

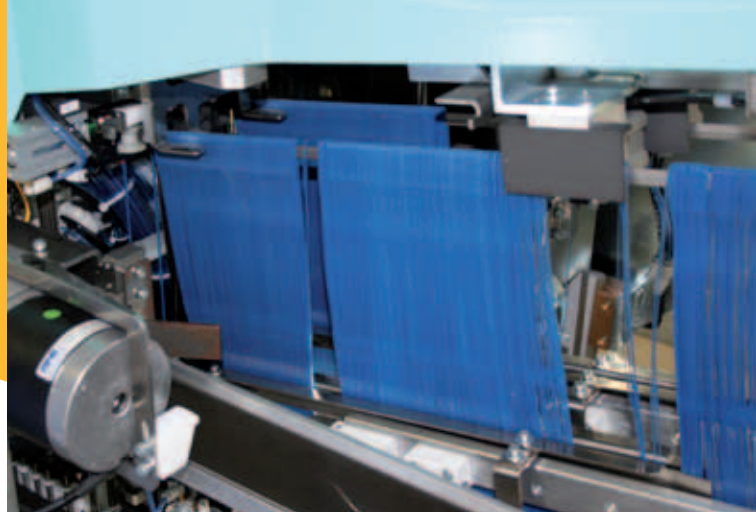

STEEL HEDDLE

Heddles

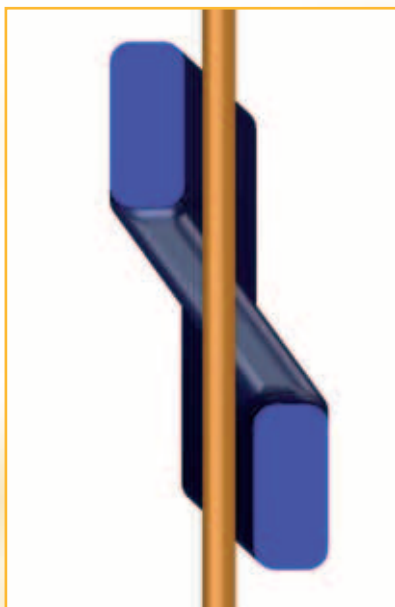

GTP Global Textile Partner will present our new generation of heddles, which include the **Dura Weave**, **Power Weave**, **Hydro Weave**, **Silk Weave** and **Eco Weave**.

- Steel Heddle® has refined the tempered stainless steel heddle, which is now named the **Dura Weave**. This new heddle has the best strength to corrosion ratio and an excellent smoothness, which guarantees the most reliable weaving performance.
- For weaving high-tension fabrics, Steel Heddle® introduces the **Power Weave**. This is also a tempered stainless steel heddle but is made out of a specially engineered alloy with superior strength and fatigue resistance for the most demanding applications.
- The **Hydro Weave** (the new non-tempered stainless steel heddle) provides a superior corrosion resistance.
- For niche markets, Steel Heddle® introduces the **Silk Weave**. This is an electroless nickel plated heddle for highly delicate fabrics such as silk. It has the smoothest heddle edges and surface on the market and this enables the best fabric quality. This heddle also features the special zero-degree eye (Jet Eye®).
- Especially for water jet weavers, Steel Heddle® will present its **Eco Weave** heddle. This heddle is made out of an exceptional synthetic-based material for use on rider harness frames. With its light weight, smooth heddle surface and integrated zero-degree eye (Jet Eye®), it provides water jet weavers with an extremely gentle warp yarn treatment.

Visitors will be able to discover at the same time the Steel Heddle specialty products, such as leno and Jet Eye® heddles - where considerable attention is placed on an optimal design that enables minimal friction between the yarn and heddle. Furthermore, the high-speed HybridPower 158 frame with carbon fiber will be on display.

GTP Global Textile Partner looks forward to welcoming all visitors to booth B03 hall E4, where our accessories specialists will be happy to provide further assistance to all weavers in selecting the best solution for their weaving applications. If you are interested in visiting ITMA ASIA + CITME, you can obtain further information at www.itmaasia.com or www.citme.com.cn.



STEEL HEDDLE

Frames

Steel Heddle® sets new record: longest frame without center support

Steel Heddle® has a long tradition of manufacturing and innovating accessories for the weaving industry. And it is now the first weaving accessories producer worldwide to introduce a frame measuring 5475 mm in width without a center support. This is an achievement which further goes to confirm its mastering of excellence. Designed for weaving at high speed to produce technical fabrics, this newly designed frame outperforms any other model in the market in terms of efficiency and reliability. The unique HybridPower 158 frame with carbon strips gives the frame the required stability to easily run at high speeds and without center support. Over 40,000 HybridPower 158 frames have already been supplied to customers around the world.

STEEL HEDDLE

Heddles

New high-tech finishing line for flat steel heddles put into operation

GTP's American subsidiary, Steel Heddle®, has invested in a new high-tech finishing line for flat steel heddles, which was put into operation in 2009. This project involved automating the various stages of finishing the flat steel heddles. The new line was developed by Steel Heddle® and a local constructor. In total, it measures 3 meters in width, 15 meters in length and 3 meters in height. This new line enables a faster finishing. Additionally the finer polishing of the heddles and the protective oxidation layer allows us to provide customers with an even smoother heddle. This offers the advantage of less risk of filamentation of the warp thread and a nice bonus is an improved lustre on the heddles.



GTP increases presence

on the worldwide web



At GTP Global Textile Partner, we are continuing to increasingly project our profile as the expert in the area of weaving accessories. With over 110 years of expertise in delivering reliable weaving accessories and thousands of valued customers around the globe, GTP is the ideal partner to achieve the best performance from your loom in a cost-efficient manner.

We decided to start up a blog to share our experiences in weaving accessories with the outside world. On our new blog site <http://weavingaccessories.blogspot.com/>, you can find information on new products, upcoming events and optimal weaving performing tips. We also encourage readers to share their ideas directly on our blog to ensure we are on the right track to help you in optimizing your loom performance. In addition to our global website www.globaltextilepartner.com, GTP has also launched a new website for Chinese customers. This new Chinese platform hosts information about weaving accessories and news about products and events in China. The GTP Chinese website can be viewed by visiting <http://www.gtp-china.com>.

We always like to receive feedback regarding our newsletter. Please mail your comments to sales@globaltextilepartner.com. If you no longer wish to receive our newsletter, please e-mail us at the same address, writing 'UNSUBSCRIBE' as the subject title.

You can also visit our website at: www.globaltextilepartner.com.

Editor: Philip De Bie, GTP Global Textile Partner,
Ter Waarde 50, BE-8900 Ypres, Belgium, +32 57 22 28 97.

GTP Global Textile Partner

K. Steverlyncklaan

8900 Ieper

Belgium

Tel.: +32 57 22 28 97

Fax: +32 57 22 21 07

GTPinfo@globaltextilepartner.com

www.globaltextilepartner.com



Global Textile Partner